

PETITION.

Be it Remembered, That on the 8th day of April, 1915, a road petition signed by A. J. Lenz and J. G. others, was presented to the Board of County Commissioners of Ford County, Kansas, praying for the establishment of a certain road described as follows, to wit:

Beginning at a point between sections 17 and 18 township 27 range 23 on the north side of the C. R. I. & P. right-of-way, thence south across said right-of-way, following the section lines as near as practicable between sections 19 & 20, 29 & 30, 31 & 32, and terminating at the southeast corner of section 31 township 27 range 23, said road to be 40 feet wide

BOND.

SAID PETITION was accompanied with bond, as required by law, signed by A. J. Lenz as principal and G. C. Lenz and W. H. Gould as sureties, in the penal sum of all costs accruing in case said road be rejected DOLLARS (\$.....);

WHEREAS, It appearing to the satisfaction of the Board that the law had been substantially complied with, and the surety of the bond being considered sufficient, the bond was approved, and W. H. Davis, C. R. Aten and W. J. Davies were appointed Viewers and Appraisers of the road which it is proposed to establish with instructions to meet in conjunction with the County Surveyor, at the beginning of said route as described above, in Ford Township, on the 19th day of May, 1915, at o'clock M., and proceed to view the said road according to law, giving to all parties a hearing, and make due report of their proceedings to the County Board.

Appointment of Viewers.

Proof of Public Notice.

(First published April 29, 1915.) Road Notice. State of Kansas, Ford County, ss. To Whom It May Concern: Take Notice, That a legal petition signed by A. J. Lenz and other householders of Ford Township, in said County, has been presented to the Board of County Commissioners, praying for the location of a public road, as follows, viz.: Beginning at a point between sections 17 and 18, township 27, range 23, on the north side of the C. R. I. & P. right-of-way, thence south across said right-of-way, following the section lines as near as practicable, between sections 19, 20, 29 and 30, 31 and 32, and terminating at the southeast corner of section 31, township 27, range 23, said road to be forty feet wide. And that said Board has appointed W. H. Davis, C. R. Aten and W. J. Davies Viewers, who will meet at the point of beginning of said road, as positioned for on the 19th day of May, 1915, and proceed to view said road, as the law directs, at which time and place all persons interested may attend and have a hearing. In case said Viewers fail to meet on the day designated, they may meet on the following day, as provided by law, without further notice. Witness my hand and the official seal of said County, this 28th day of April, 1915. H. N. KINKREAD, County Clerk.

AFTERWARD, To wit, on the 9th day of June, 1915, H. N. Kinkread, County Clerk, presented to said Board his certificate, under seal, setting forth that pursuant to law he had caused public notice of said proposed road establishment to be published in The Dodge City Globe (a weekly newspaper published in Dodge City, Kansas,) for two consecutive weeks, and said notice was so published in said newspaper on the 29th day of April, 1915, the 29th day of April, 1915, and the 6th day of May, 1915, and had also caused similar notice to be posted to public view upon the bulletin board in his office from April 28th, 1915, to June 9th, 1915, and similar notices to be publicly posted in the following places, to wit:

....., 19....., at in Township, 19....., at in Township, 19....., at in Township,

to be made in County Commissioners' Journal, Volume "E," page "472." day of June, 1915, there was presented to said County Board the affidavit of one of the petitioners aforesaid, setting forth that due notice of the establishment meeting of the Viewers, as per published notice of County Clerk, had been served upon each of the persons, or guardians, were all the persons through whose premises said road is proposed to be established.

Petitioner's Affidavit of Service of Notice.

Table with columns: NAME OF PERSON, OWNER, AGENT, OR GUARDIAN, FRACTIONAL PART, Sec., Twp., RANGE, REMARKS. Includes entries for C. R. I. & P. Ry. Benlar Agent, R. P. Grassure, Frank Seely, P. H. Young, E. K. Batsman, Linn Invisit Co., Francis B. Odell, Eugene Taylor.

Road No. 373 ROAD RECORD,

(Prepared by State Commission, under Chapter 886, Laws of 1911.)

PETITION.

Be it Remembered, That on the 8th day of April, 1915, a road petition signed by A. J. Lenz and L. G. others, was presented to the Board of County Commissioners of Ford County, Kansas, praying for the establishment of a certain road described as follows, to wit:

Beginning at a point between sections 17 and 18 township 27 range 23 on the north side of the C. R. & P right-of-way, thence south across said right-of-way, following the section lines as near as practicable between sections 19 & 20, 29 & 30, 31 & 32, and terminating at the southeast corner of section 31 township 27 range 23, said road to be 40 feet wide

BOND.

SAID PETITION was accompanied with bond, as required by law, signed by A. J. Lenz as principal and L. G. Lenz and W. H. Good as sureties, in the penal sum of all costs accruing in case said road be rejected DOLLARS (\$.....);

Appointment of Viewers.

WHEREAS, It appearing to the satisfaction of the Board that the law had been substantially complied with, and the surety of the bond being considered sufficient, the bond was approved, and W. H. Davis and C. R. Atten and W. J. Davies were appointed Viewers and Appraisers of the road which it is proposed to establish with instructions to meet in conjunction with the County Surveyor, at the beginning of said route as described above, in Ford county of May, 1915, at o'clock M., and proceed to view the said road as a hearing, and make due report of their proceedings to the County Board.

Proof of Public Notice.

AFTERWARD, To wit, on the 9th day of June, 1915, H. N. Kirkhead, County Clerk, presented to said Board his certificate, under seal, setting forth that pursuant to law he had caused public notice of said proposed road establishment to be published in The Dodge City Globe (a weekly newspaper published in Dodge City, Kansas,) for two consecutive weeks, and said notice was so published in said newspaper on the day of 1915, the 29th day of April, 1915, and the 6th day of May, 1915, and had also caused similar notice to be posted to public view upon the bulletin board in his office from April 28th, 1915, to June 9th, 1915, and similar notices to be publicly posted in the following places, to wit:

From....., 19....., to....., 19....., at....., in..... Township,
From....., 19....., to....., 19....., at....., in..... Township,
From....., 19....., to....., 19....., at....., in..... Township,
and had also caused record of same to be made in County Commissioners' Journal, Volume "E," page "472."

Petitioner's Affidavit of Service of Notice.

ALSO, Upon said 9th day of June, 1915, there was presented to said County Board the affidavit of A. J. Lenz, one of the petitioners aforesaid, setting forth that due notice of the establishment of said road, together with date of meeting of the Viewers, as per published notice of County Clerk, had been served upon each of the persons noted below, who, as owners, agents, or guardians, were all the persons through whose premises said road is proposed to be established, to wit:

DATE WHEN NOTICE WAS SERVED	NAME OF PERSON	OWNER, AGENT, OR GUARDIAN	FRACTIONAL PART	SEC.	TWP.	RANGE	REMARKS
May 1st 1915	C. R. & P. Ry.	Penka Agent	R.R. Crossing	17-18	27	23	
" "	R. P. Trasure	Owner	SW ¹ 17 & NW ¹	20	"	"	
" "	"	"	SW ¹ 29 & W ²	32	"	"	
" 5th	Frank Seely	"	SE ⁴	19	"	"	
" "	P. H. Young	"	SE ⁴ 18 & NE ⁴	19	"	"	
" "	E. K. Bateman	"	SW ⁴	20	"	"	
" 8th	Lincoln Lumber Co.	"	NE ⁴	30	"	"	
" "	Francis B. Odell	"	SE ⁴	30	"	"	
" 5th	Eugene Taylor	"	E ²	31	"	"	

SURVEYOR'S REPORT.

ALSO, Upon said 9th day of June, 1915, B. L. Glenn, County Surveyor, presented to said County Board his report of survey of the road which it is proposed to establish, plat and field notes, in words and figures as follows, to wit:

Having been ordered by your Honorable Board to meet with C. R. Aten, W. J. Davis, and W. H. Davis, Road Viewers, at the specified place of beginning, in Ford Township, on the 19th day of May, 1915, and under the direction of said Viewers to survey said road, the establishment of which had been petitioned for, respectfully represent and report to your Honorable Board, that on the 19th day of May, 1915, at said designated place, I did meet with the said Viewers, and did, under their direction, survey the road and cause the same to be conspicuously marked throughout, noting the courses and distances, which survey was as follows, viz: but accepted the apparent lines as now located presumably on the Van Tromp survey

The place of beginning is about 8.00 chains north of the place for the corner to sections 17, 18, 19 & 20.

The line will be duly located for the railroad crossing. No measurements were taken, but the records were copied from the Charles Van Tromp plat for this plat.

And a plat of said road so surveyed is hereto attached as a part of this return:

Twp. 27 S. Rng. 23 W.

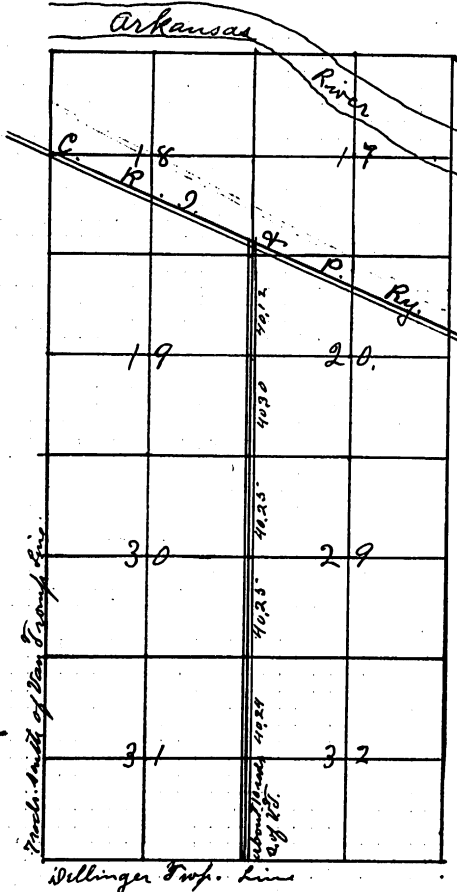

ROAD RECORD,

VIEWERS' REPORT OF VIEW.

Report of View.

ALSO, Upon said 9th day of June, 1915, said C. R. Aten, W. J. Davies and W. H. Davis, Viewers, presented to said County Board their several reports, as follows, to wit:

The undersigned, who were appointed by your Honorable Body to view the road the establishment of which had been petitioned for by A. J. Lenz and others, of Ford Township, met as directed, at the beginning point of the road proposed to be established and having taken to our assistance as chain carriers and as marker, proceeded to view the route as petitioned for, or as nearly so as practicable, and the same was surveyed under our direction by the County Surveyor. We took into consideration the utility, convenience and inconvenience and expense which would result to individuals and to the public should said road or any part thereof be established, vacated or altered, and respectfully report that in our opinion, and for the reasons stated, said road should be allowed.

(Proceed to complete your report by writing in the findings of the Viewers for or against the prayer of the petitioners, and your reasons therefor.)

We recommend that the width of said road be 40 feet.

(Signed) C. R. Aten, Viewer.
 (Signed) W. H. Davis, Viewer.
 (Signed) W. J. Davies, Viewer.

VIEWERS' REPORT OF DAMAGES.

Viewers' Report of Damages.

Your Viewers, appointed to view and assess damages on the road petitioned for by A. J. Lenz and others of Ford Township, respectfully report that said road was viewed by us on the 19th day of May, 1915, and that the following-named persons, being owners, agents or guardians, filed with us, at the time of said view, their several written applications for compensation or damages claimed on account of said road, as petitioned for, and we have made careful estimate of the actual damage to each and assessed the same as shown below opposite each separate tract of land. The written applications of land-owners for damages, as filed with us, are herewith returned.

AGENT OR GUARDIAN	OWNER	DESCRIPTION OF LAND	S.	T.	R.	Acres Appropriated	AMOUNT CLAIMED	AMOUNT ALLOWED BY APPRAISERS
	<u>R P Frause</u> <u>Moving</u>	<u>S 20 1/2 NW 20 SW 29 1/2 W 2</u> <u>650 rods. Old fire</u>	<u>3</u>	<u>27</u>	<u>23</u>		<u>31 00</u>	<u>31 00</u>

(Signed) C. R. Aten, Appraiser.
 (Signed) W. H. Davis, Appraiser.
 (Signed) W. J. Davies, Appraiser.

WHEREUPON, On the 9th day of June, 1915, the following action thereon was had by said Board of County Commissioners, to wit:

The reports of Viewers having been read before the Board of County Commissioners, and said report being favorable, and no legal objections appearing against the same, and the Board being satisfied that the establishment of such road will be of public utility, do hereby order the establishment of said road and (in case of alteration or establishment) designate the same as a Township road. It is further ordered that proper record be made of said road proceedings, survey and plat, and that the County Surveyor direct and require the Township Trustee of township through which said road or any portion thereof runs, in case of mail routes or township roads, or County Engineer in case of State or County roads, to cause the road to be opened for public travel.

ALSO, It is hereby ordered that the award of damages be, and the same is hereby made, in accordance with the assessment of Viewers as per their report, with the following exceptions, viz.:

PROVIDED, That such sums shall become due and payable only upon the filing of a certificate from the Township Trustee or County Engineer, as the case may be, that the road has actually been opened for public travel.

(L. S.)

I CERTIFY, That the foregoing is a complete record of the action of the Board of County Commissioners, which action was had on the 9th day of June, 1915, and recorded on page 1197 Book E, Commissioners' Journal, as required by law.

H. N. Kinkead, County Clerk.

Pursuant to instructions from the Board of County Commissioners, notice was given to the following-named officials, directing and requiring them to cause to be opened for public travel the within-described road:

Surveyor's Notice to Open.

NAME	OFFICIAL	TOWNSHIP	ADDRESS	MANNER OF NOTICE AND DATE
R. B. Hageman	Trustee	Ford	Ford City Km	Letter Sept 3 1915

Advice has been received from the following-named persons, stating that, pursuant to instructions, each has caused to be opened for public travel all that portion of said road which comes within his official jurisdiction:

Road Opened.

NAME	OFFICIAL	TOWNSHIP	DATE OPENED

I HEREBY CERTIFY, That the foregoing is a true and complete record of the proceedings in connection with the establishing of the within-described road which by law is required to be made, and the same was recorded by me, this 3rd day of Sept, 1915.

B. L. Glenn, County Surveyor.